

- 30 Limpsfield Ward
Nutfield Ward
- 31 Leigh Ward
Newdigate Ward
- 32 Buckland Ward
Tandridge Ward
Urology Unit
- 33 High Dependency Unit (HDU)
Intensive Care Unit (ICU)
- 34 Theatres 1 - 8
- 35 Restaurant
- 36 Day Surgery Centre
- 37 Outwood Ward
Child Assessment Unit (CAU)
- 38 Delivery Suite
Neo Natal Unit
- 39 Brockham Ward
Rusper Ward
Early Pregnancy Unit (EPU)
- 40 Birthing Centre
Burstow Ward
Obstetric Ultrasound
- 41 Tilgate Ward
- 42 Brook Ward
- 43 Charlwood Ward
- 44 Princess Alexandra Theatres
- 45 Kingsfold Unit
- 46 Tilgate Annex

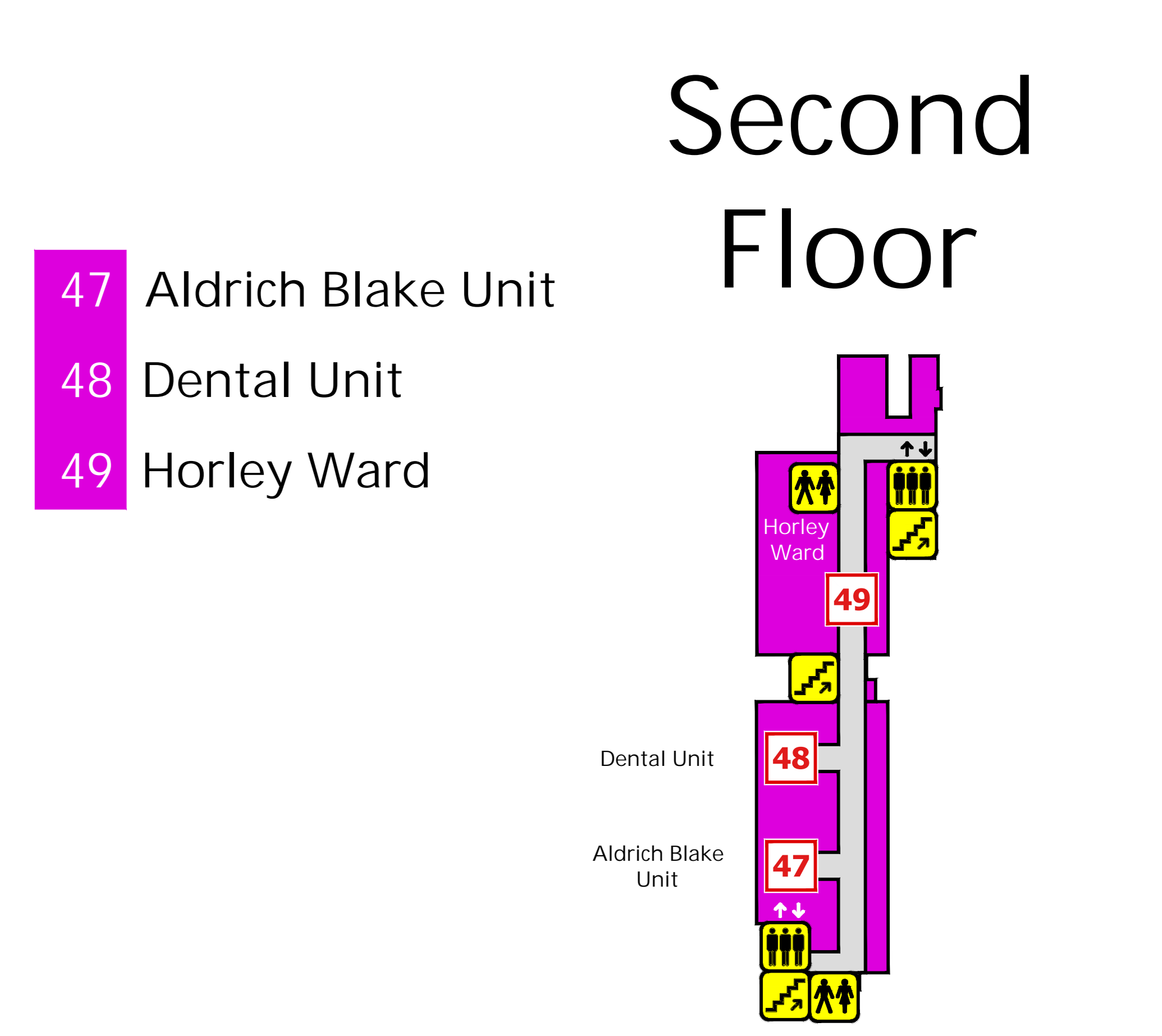
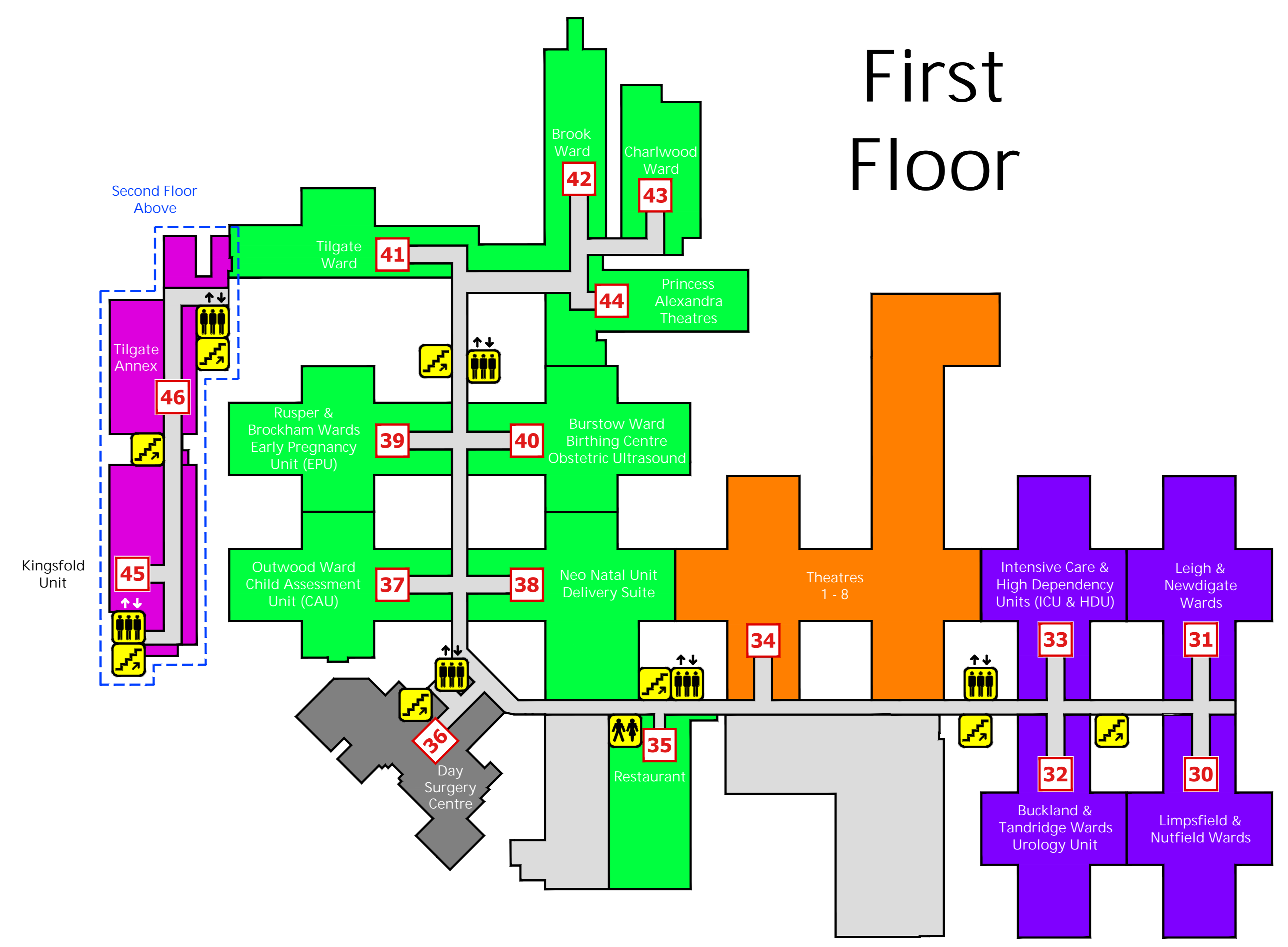

East Surrey Hospital Way Finding Map

Canada Avenue
Redhill Surrey RH1 5RH
Tel 01737 768511
www.surreyandsussex.nhs

NHS
Surrey and Sussex Healthcare
NHS Trust

© Surrey & Sussex Healthcare NHS Trust 2021

P Visitor Parking

Please use the machines by the Main & East Entrances to pay for parking by entering your vehicle registration number. Accessible bays are exempt.

- Lift
- Stairs
- Bus Stop
- Toilets
- Cash Machine
- Parking Payment
- Changing Places
- Entrance/Exit

- 1 Trust HQ
Lecture Theatre
Post Graduate Education Centre (PGE)
- 2 Main Entrance
Reception
M&S Food
WH Smith
- 3 Fracture Clinic
- 4 Main Outpatients
Ophthalmology
- 5 Boots Chemist
- 6 Emergency Department
- 7 Diagnostic Imaging
CT MRI
Nuclear Medicine
Radiology
Ultrasound
X-Ray
- 8 Haematology
Phlebotomy
- 9 Acute Medical Unit (AMU)
- 10 Chipstead Outpatients
Holmwood Ward
- 11 Angiography
Cardiac Care Unit (CCU)
Cardiology
- 12 Temporary Staff Bureau
- 13 Discharge Unit
Chapel
- 14 Bletchingley Ward
Hazelwood Ward
Pendleton Unit
- 15 Therapies
Dermatology
Dietetics
Podiatry
Speech & Language
- 16 Godstone Ward
Godstone Haematology
Chemotherapy Suite
- 17 Abinger Ward
Meadvale Ward
- 18 Capel Ward
- 19 Chaldon Ward
- 20 St. Lukes Radiotherapy
- 21 Pre-Assessment
Surgical Admissions
- 22 Endoscopy
- 23 Brook Ward
- 24 Charlwood Ward
- 25 Smallfield Ward
- 26 Integrated Reablement Unit (IRU)
- 27 Capel Annex
- 28 Macmillan Building
- 29 Children's Outpatients

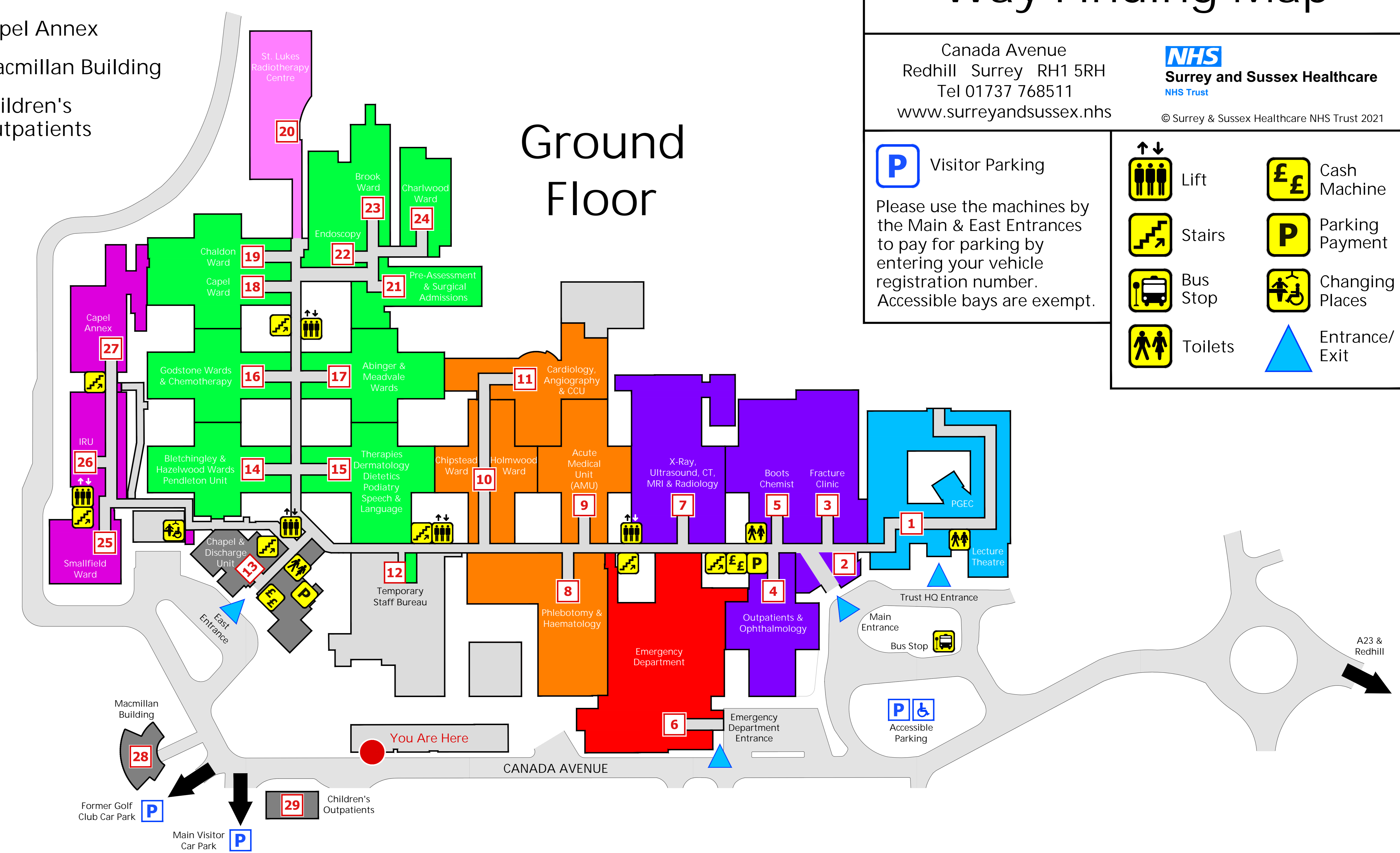

A23 & Redhill